

45

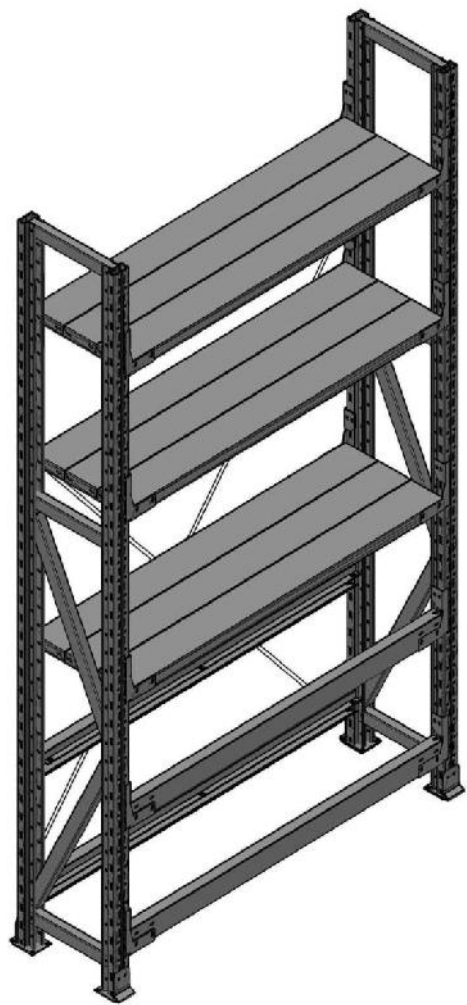

1. 45 , - /

1.1. 45 1,5 - 50 ,

1.2. -) - 2 , 4 (-

1.3. - 6 14. , 1, 2 3 .

2. : - (. .1). 2- 6 14 2- 6.

2- 8 30 2- 8 , (. .2). () !

!

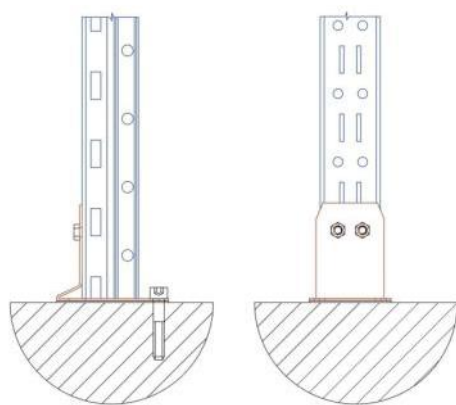

.1

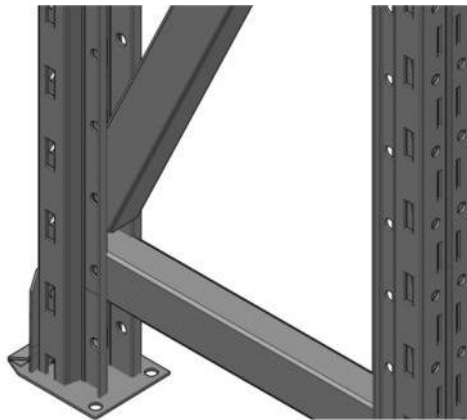

.2

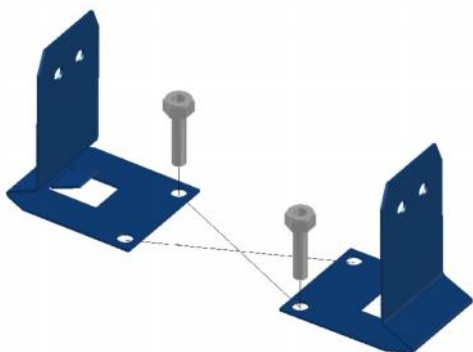

.3

6 50 = 2 (. .3). 1 .

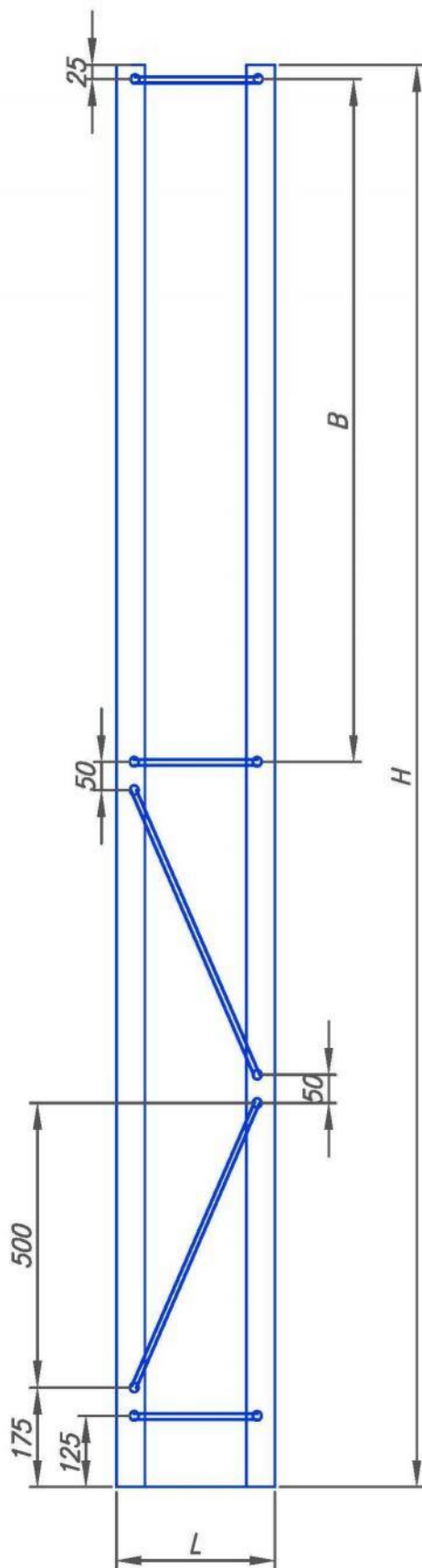

| Н, мм | Количество горизонтальных связей | Количество диагональных связей | 700<B<1500 |
|-------|----------------------------------|--------------------------------|------------|
| 2000 | 3 | 2 | 700 |
| 2100 | 3 | 2 | 800 |
| 2200 | 3 | 2 | 900 |
| 2300 | 3 | 2 | 1000 |
| 2400 | 3 | 2 | 1100 |
| 2500 | 3 | 2 | 1200 |
| 2600 | 3 | 2 | 1300 |
| 2700 | 3 | 2 | 1400 |
| 2800 | 3 | 2 | 1500 |
| 2900 | 3 | 3 | 1050 |
| 3000 | 3 | 3 | 1150 |
| 3100 | 3 | 3 | 1250 |
| 3200 | 3 | 3 | 1350 |
| 3300 | 3 | 3 | 1450 |
| 3400 | 3 | 4 | 1000 |
| 3500 | 3 | 4 | 1100 |
| 3600 | 3 | 4 | 1200 |
| 3700 | 3 | 4 | 1300 |
| 3800 | 3 | 4 | 1400 |
| 3900 | 3 | 4 | 1500 |
| 4000 | 3 | 5 | 1050 |
| 4100 | 3 | 5 | 1150 |
| 4200 | 3 | 5 | 1250 |
| 4300 | 3 | 5 | 1350 |
| 4400 | 3 | 5 | 1450 |
| 4500 | 3 | 6 | 1000 |
| 4600 | 3 | 6 | 1100 |
| 4700 | 3 | 6 | 1200 |
| 4800 | 3 | 6 | 1300 |
| 4900 | 3 | 6 | 1400 |
| 5000 | 3 | 6 | 1500 |
| 5100 | 3 | 7 | 1050 |
| 5200 | 3 | 7 | 1150 |
| 5300 | 3 | 7 | 1250 |
| 5400 | 3 | 7 | 1350 |
| 5500 | 3 | 7 | 1450 |
| 5600 | 3 | 8 | 1000 |
| 5700 | 3 | 8 | 1100 |
| 5800 | 3 | 8 | 1200 |
| 5900 | 3 | 8 | 1300 |
| 6000 | 3 | 8 | 1400 |

.3

3.
4.

(.2.).

:

– (. .4).

(. .5.1 5.2).

6 14

6.

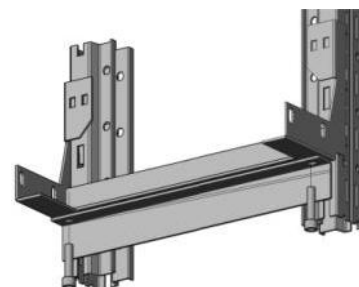
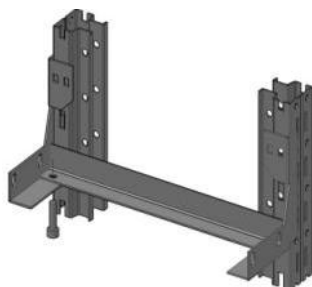

.4

.5.1 ()

.5.2 (-)

(. .6),

6 (. .7 8),

6 10

.(. .8).

6 14

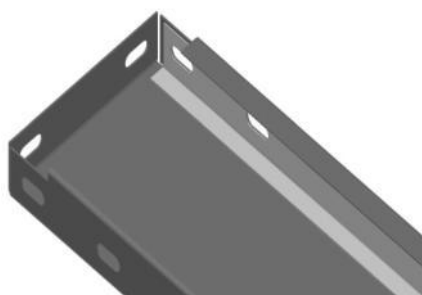

.6

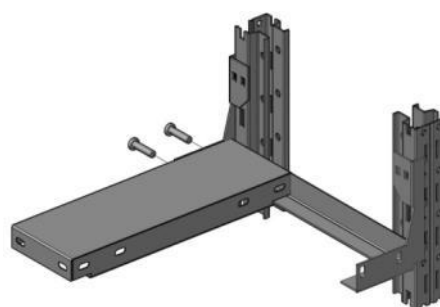

.7

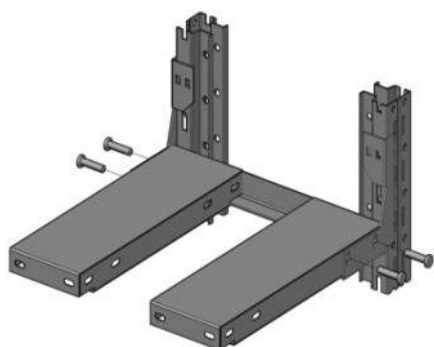

.8

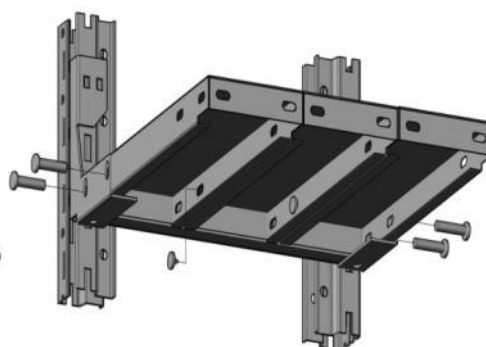

.9

5.

*

6.

6 14 , 3- 6 - (. .4). (. .9), 3- (. .9)

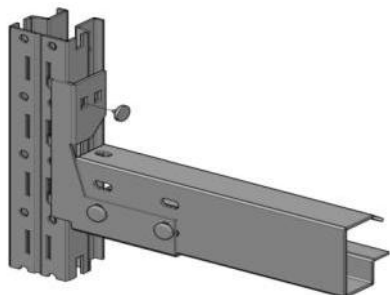

.9

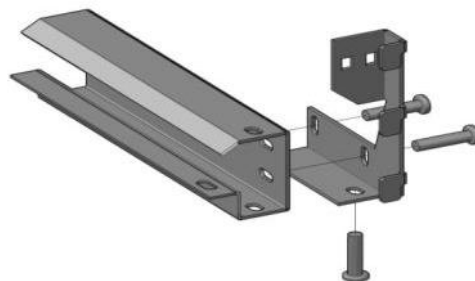

.10

! 60 30 - (. .11.1) (. .11.2) -

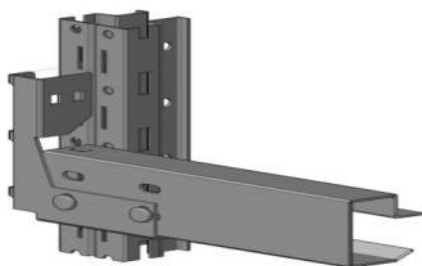

.11.1 ()

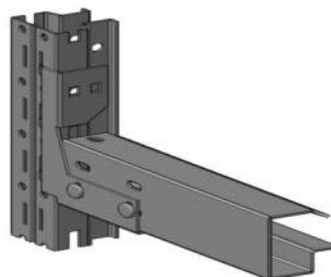

.11.2 ()

7.

1, 2 3

| 60 30 | 700-1500 | 1750 | 1820 | 2000 | 2250 | 2500 |
|--------|----------|-------|-------|-------|-------|-------|
| (1-) | 200 . | 200 . | 190 . | 170 . | 150 . | 120 . |
| (2-) | 400 . | 370 . | 350 . | 320 . | 300 . | 250 . |
| (3-) | 600 . | 550 . | 500 . | 450 . | 400 . | 350 . |

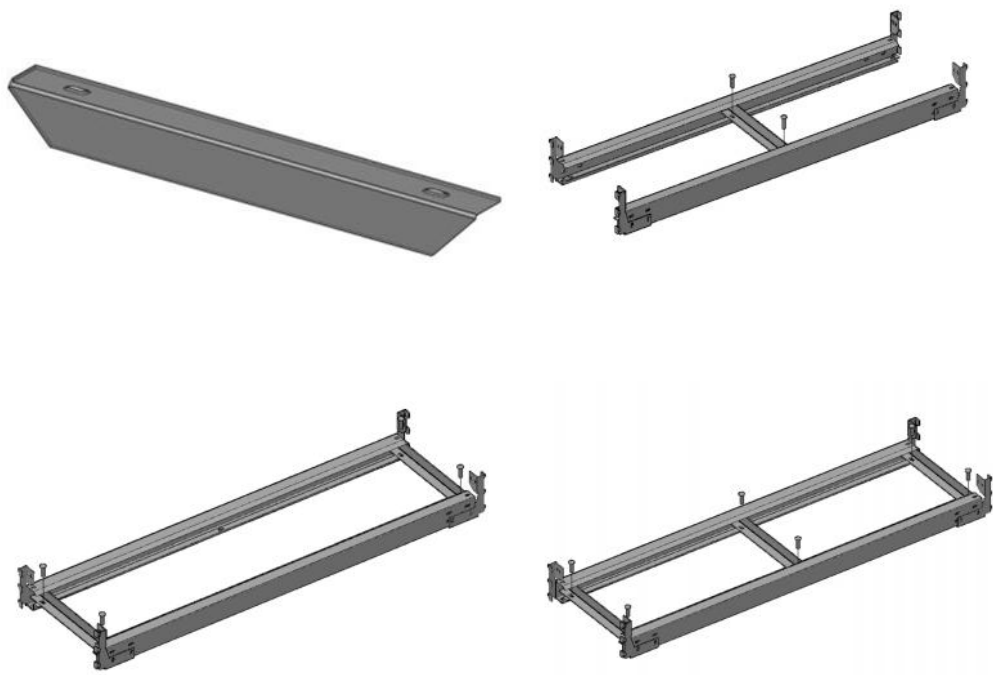

!

7. : -1 -2 2 ,, 6 -

2 6 14 - 4 (

3)

| | | | | |
|--|------|------|------|------|
| | 2000 | 3000 | 3000 | 6000 |
| | 1 | | 2 | |

Установка крестовин в СТУ

Крестовины устанавливаются в
отдельностоящих стеллажах.
В линейках устанавливаются в крайних
секциях и каждой третьей

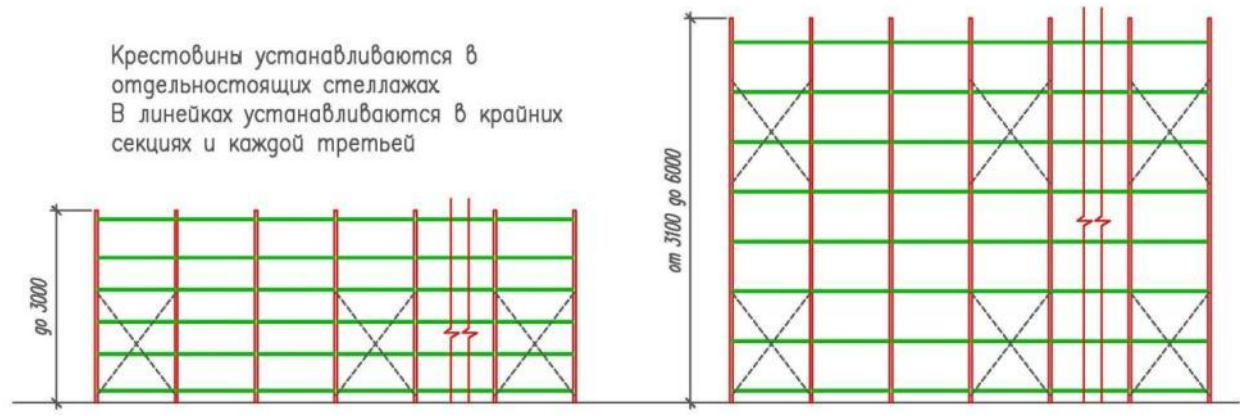

8.

9.

2



Полочный

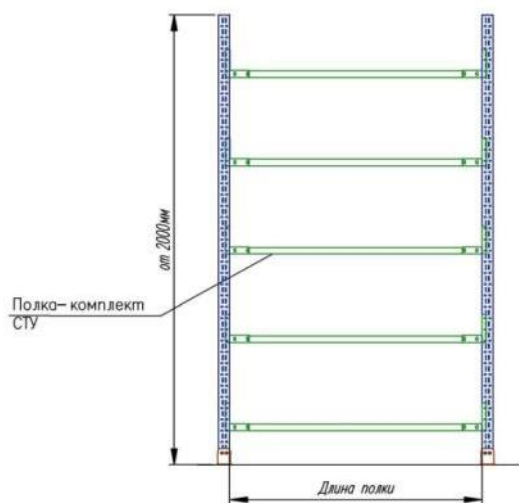

Комбинированный (балки и полки)

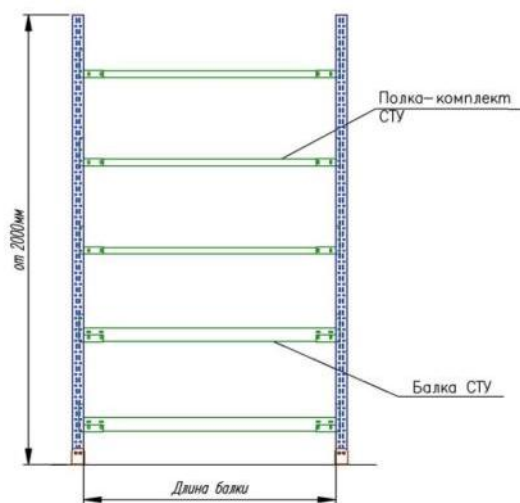

Комбинированный (СП и СТУ)

